

**REVISÉD-----AYS0 REGION 121 SIMI VALLEY FALL 2023 FIELD MAP**

**LEEDS ST.**

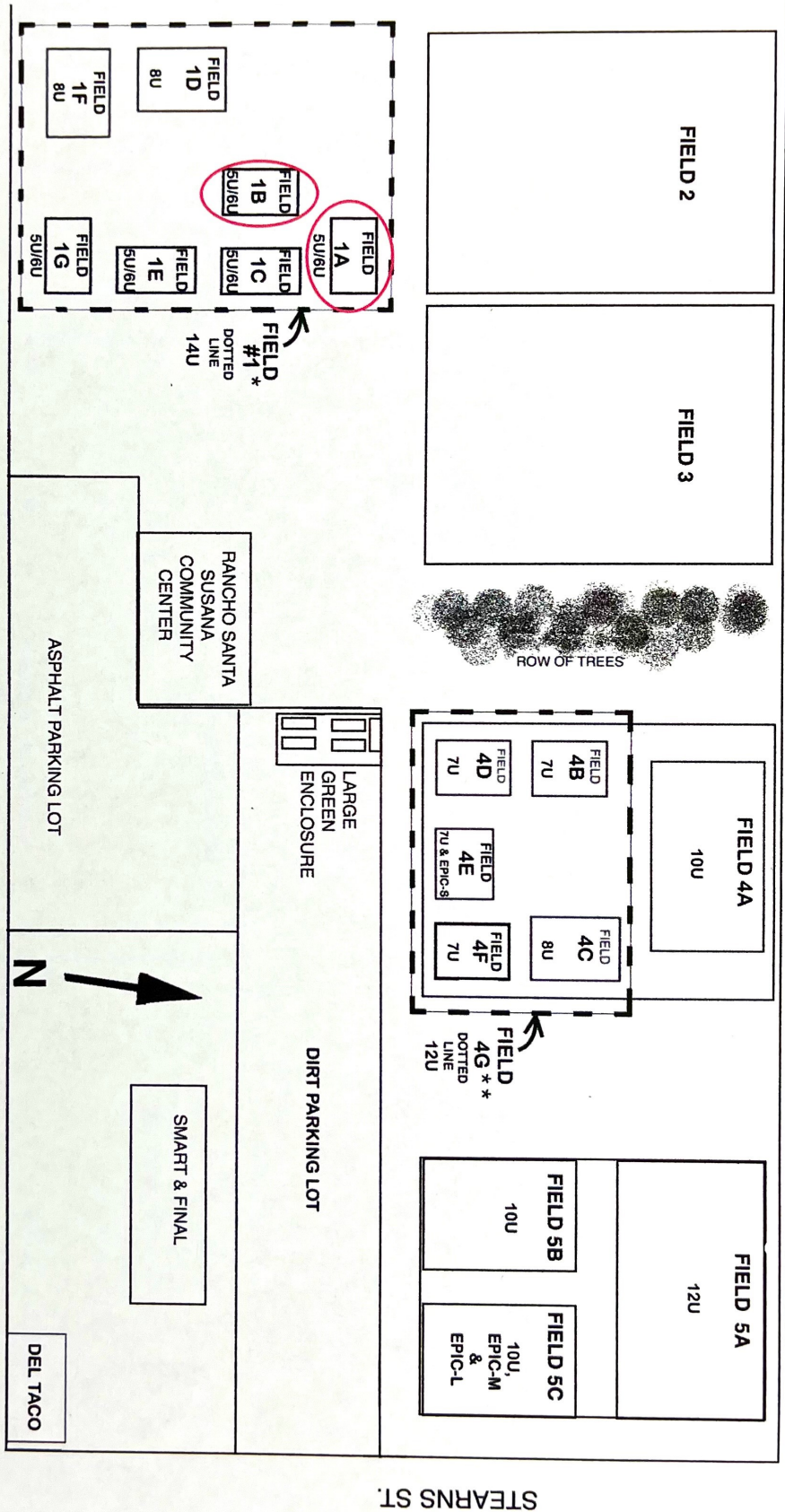

**IMPORTANT GAMEDAY INFO--FIELD SETUP AND TAKEDOWN VOLUNTEERS TAKE NOTE:**

1. Each team playing the first game of the day for their age group must set up the field on which they will play. Setup/Takedown Volunteers (as listed on their team's Volunteer Sheet) are to paint their assigned field, spectator and coaching lines with two heavy coats of paint and assemble/position the goals on that field. Games will not be started until field preparation is complete. Game time will be shortened accordingly.
2. For most age groups, the first game of the day starts at 8:00. Setup Volunteers must be at the field to prepare for the game at 7:15.
- \*3. All 14U games are on Field #1. The first game of the day on Field #1 will begin at 11:00. Setup Volunteers must be at the field to prepare for the game at 10:15.
- \*\*4. The first 12U games on Field #4G begin at 11:00. Setup Volunteers must be at the field to prepare for the game at 10:15.
5. Teams playing the last game of the day, which starts at 12:30, may be required to paint the field lines after the game, depending on their condition.
6. The last games of the day for 5U-8U start at 9:15. The last games of the day for 10U-14U start at 12:30.  
Teams playing the last game of the day for their age group are required to disassemble and bag the temporary goals. For temporary goals made with square aluminum tubing, please leave the net securely on one of the goal segments so that it does not slip off. Teams playing on fields with permanent goals will be directed where to move those goals.
7. The home team is listed first in the schedule and sits on the north or west half of the touch line (sideline).